

SECTION 5 PARTS LIST

SAFETY PRECAUTION

Parts identified by the \triangle symbol are critical for safety. Replace only with specified part numbers.

5.1 PACKING AND ACCESSORY ASSEMBLY <M1>

The instruction manual to be provided with this product will differ according to the destination.

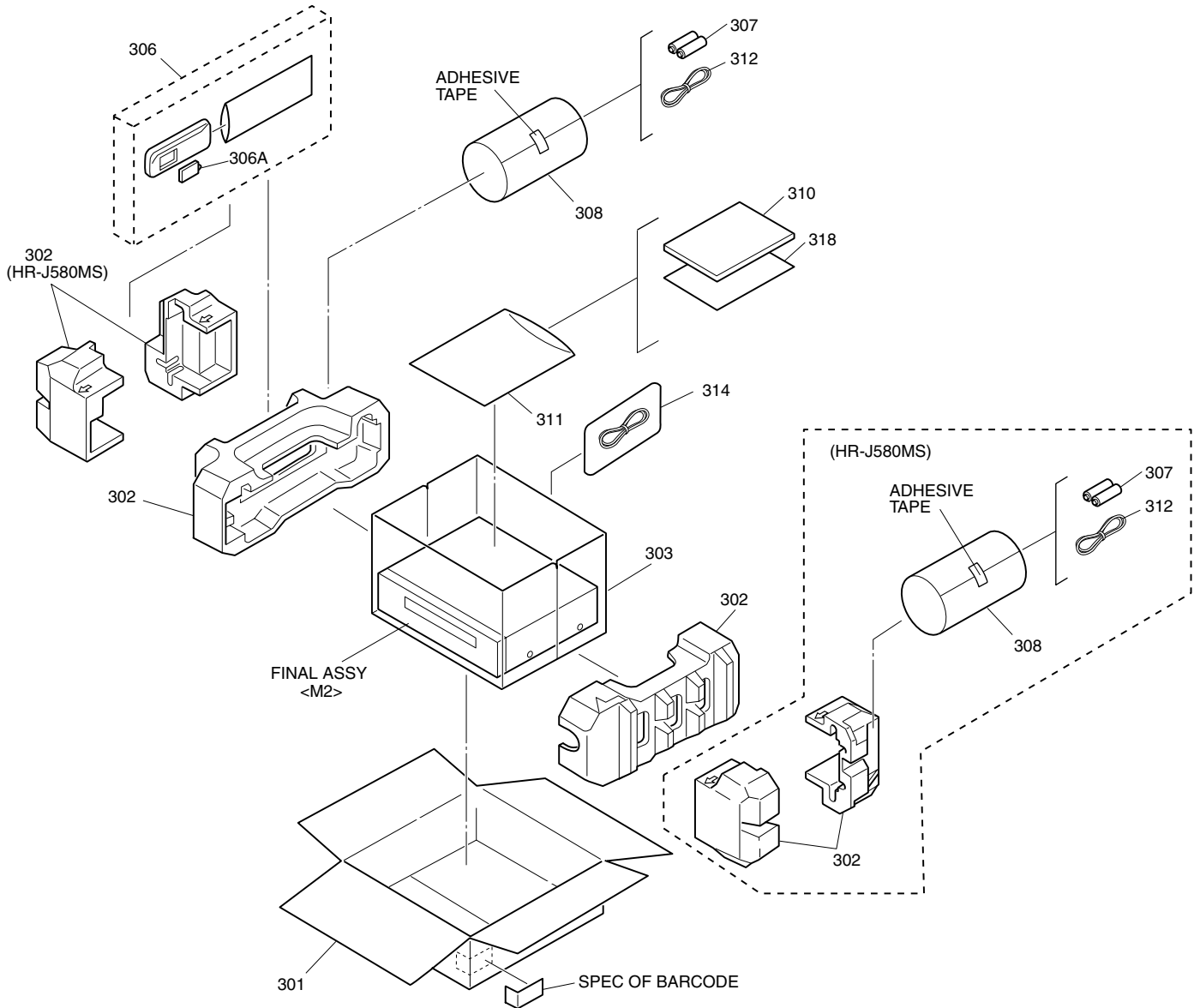

# \triangle REF No.	PART No.	PART NAME, DESCRIPTION	# \triangle REF No.	PART No.	PART NAME, DESCRIPTION	

PACKING AND ACCESSORY ASSEMBLY <M1>						
301	LP30897-001A	PACKING CASE, J580MS		306A	LP40610-002A	COVER(BATTERY)
	LP30855-001B	PACKING CASE, J680MS/J780MS/J781MS		307	-	BATTERY, X2("R6" TYPE)
302	LP30898-001A	CUSHION ASSY, J580MS		308	QPC02202230P	POLY BAG
	LP30909-001B	CUSHION ASSY, J680MS/J780MS/J781MS		\triangle 310	LPT0489-001A	INST.BOOK(FR), J680MS
303	PQM30021-93	POLY BAG		\triangle	LPT0491-001B	INST.BOOK(FR), J780MS/J781MS
306	LP20878-002A	REMOTE CONTROLLER		\triangle	LPT0571-001A	INST.BOOK(FR), J580MS
				311	QPC02503530P	POLY BAG
				312	PEAC0300-02	RF CABLE
				314	QAM0238-003	PERI CABLE
				318	BT-54008-2	GUARANTY CARD

△ REF No. PART No. PART NAME, DESCRIPTION

△ REF No. PART No. PART NAME, DESCRIPTION

FINAL ASSEMBLY <M2>

△ 501	LP10293-029C	FRONT PANEL ASSY
501A	LP20868-031A	CASSETTE DOOR
501B	PQ46448	TORSION SPRING
501D	LP20869-085B	DISPLAY WINDOW
501E	LP30649-005A	ORNAMENT
△ 502	PQ11898-52-23	TOP COVER
503	QYTDSF3010R	SCREW,X4 TOP COVER(SIDE)
504	QYTDSF3010M	SCREW,TOP COVER(REAR)
505	LP20981-009A	DRUM SUB ASSY
505E	LP40323-001A	CONTACT
505F	LP30004-014A	COMPRESSION SPRING
506	PDZ0179-1-4	ROTOR ASSY
507	QYSPSP3006Z	SCREW,X2
△ 508	QAR0169-002	STATOR ASSY
509	QYSPSPH2606Z	SCREW,X2
510	QYTDST2610Z	SCREW,X3,DRUM
△ 511	LP21026-001C	BOTTOM CHASSIS
△ 512	PQ11899-3-7	BOTTOM COVER
513	LP30312-001B	BRACKET(CHASSIS)
514	QYTDSF3010Z	SCREW,X2,BRACKET(CHASSIS)
515	QYTDSF4012Z	SCREW,MECHA
516	QYTDSF3010Z	SCREW,X2,MECHA
△ 517	QMP4A10-170	POWER CORD
522	LP40226-001A	PC SUPPORT,X2
523	QYTDSF3010M	SCREW,TERMINAL BOARD
524	LP40253-001B	STOPPER
525	PQ40413	SPECIAL SCREW,MECHA
527	LP30356-002C	DRUM SHIELD
528	QYTDST2606Z	SCREW,X2,DRUM SHIELD
529	LP30002-042A	SPACER,MAIN
530	QYTDSF3010Z	SCREW,MAIN
531	DPSF3010Z	SCREW,X3,MAIN
534	LP40628-001B	PC SUPPORT,MINI FRONT
535	LP40854-001A	BRACKET
536	QYTDSF3010Z	SCREW
WR1	QUQ212-0518CG	FFC WIRE,DRUM CN3001
WR2	WJT0005-001A	E-CARD WIRE,A/C HEAD CN2001
WR3	QUQ112-0914CG	FFC WIRE,FRONT CN7001

Δ REF No. PART No. PART NAME, DESCRIPTION

FINAL ASSEMBLY <M2>

Δ 501	LP10333-015D	FRONT PANEL ASSY,J680MS
	LP10333-016E	FRONT PANEL ASSY,J780MS
	LP10333-024D	FRONT PANEL ASSY,J781MS
501A	LP20961-001B	CASSETTE DOOR
501B	PQ46448	TORSION SPRING
501C	LP30798-001A	BUTTON(OPE),J680MS
Δ 502	LP10013-051A	TOP COVER
503	QYTDSF3010R	SCREW,X4 TOP COVER(SIDE)
504	QYTDSF3010M	SCREW,TOP COVER(REAR)
505	LP20981-009A	DRUM SUB ASSY
505E	LP40323-001A	CONTACT
505F	LP30004-014A	COMPRESSION SPRING
506	PDZ0179-1-4	ROTOR ASSY
507	QYSPSP3006Z	SCREW,X2
Δ 508	QAR0169-002	STATOR ASSY
509	QYSPSPH2606Z	SCREW,X2
510	QYTDST2610Z	SCREW,X3,DRUM
Δ 511	LP10108-001H	BOTTOM CHASSIS
Δ 512	LP10014-002B	BOTTOM COVER
513	LP30312-001B	BRACKET(CHASSIS)
514	QYTDSF3010Z	SCREW,X2,BRACKET(CHASSIS)
515	QYTDSF4012Z	SCREW,MECHA
516	QYTDSF3010Z	SCREW,X2,MECHA
Δ 517	QMP4A10-170	POWER CORD
522	LP40226-001A	PC SUPPORT,X2
523	QYTDSF3010M	SCREW,TERMINAL BOARD
524	LP40253-001B	STOPPER
525	PQ40413	SPECIAL SCREW,MECHA
527	LP30356-002C	DRUM SHIELD
528	QYTDST2606Z	SCREW,X2,DRUM SHIELD
529	LP30002-042A	SPACER,MAIN
530	QYTDSF3010Z	SCREW,MAIN
531	DPSF3010Z	SCREW,X3,MAIN
532	LP31019-001C	KNOB ASSY,J780MS/J781MS
533	QYTSPFG2608Z	SCREW,X2,J780MS/J781MS
WR1	QUQ212-0518CG	FFC WIRE,DRUM CN3001
WR2	WJT0005-001A	E-CARD WIRE,A/C HEAD CN2001
WR3	QUQ112-0914CG	FFC WIRE,FRONT,CN7001 J780MS/J781MS

Δ REF No. PART No. PART NAME, DESCRIPTION

5.4 ELECTRICAL PARTS LIST

#	△ REF No.	PART No.	PART NAME, DESCRIPTION

MAIN BOARD ASSEMBLY <03>			
PW1		LPA10131-13D1	MAIN BOARD ASSY,J580MS
		LPA10131-15D1	MAIN BOARD ASSY,J780MS/J781MS
		LPA10131-14D1	MAIN BOARD ASSY,J680MS
IC1		JCP8050-MVA	IC
IC201		LC74788N-9751	IC (OSD),J580MS
		LC74775-9750	IC,J680MS/J780MS/J781MS
IC301		LA7358	IC
IC3001		HD6432194SXD03F	IC (MCU)
IC3002		IC-PST3427U-X	IC
IC3003		AT24C16N-10SC-X	IC
		or BR24C16F	IC
		or X24C16S	IC
		or 24LC16B/SN-X	IC
IC3004		BA6956AN	IC
IC5301		L5431	IC
		or MM1431AT	IC
		or UTCTL431	IC
IC6701		MSP3417D	IC
		or MSP3417DG3	IC
IC7001		PT6956	IC
IC7002		GP1U291Q	IR DETECT UNIT
		or PIC-28143LJ	IR DETECT UNIT
		or PNA4652M00YC	IR DETECT UNIT
		or PIC-37143LJ	IR DETECT UNIT
IC7101		MM1443XJ	IC
Q1		2SC4081/S/-X	TRANSISTOR
Q2		2SC4081/S/-X	TRANSISTOR
Q3		2SC4081/S/-X	TRANSISTOR
Q4		2SC4081/S/-X	TRANSISTOR
Q21		2SA1576A/QR/-X	TRANSISTOR
		or 2PA1576/R/-X	TRANSISTOR
Q23		2SA1576A/QR/-X	TRANSISTOR
		or 2PA1576/R/-X	TRANSISTOR
Q34		2SA1576A/QR/-X	TRANSISTOR
		or 2PA1576/R/-X	TRANSISTOR
Q38		2SC4081/QRS/-X	TRANSISTOR
Q41		UN521E	DIGI TRANSISTOR
		or RN1309	DIGI TRANSISTOR
		or DTC144WU	DIGI TRANSISTOR
Q201		2SC4081/QRS/-X	TRANSISTOR
		or 2PC4081/R/-X	TRANSISTOR
Q301		2SA1576A/QR/-X	TRANSISTOR
		or 2PA1576/R/-X	TRANSISTOR
Q302		DTA144WU	DIGI TRANSISTOR
		or PDA144WU	DIGI TRANSISTOR
		or RN2309	TRANSISTOR
		or UN511E	DIGI TRANSISTOR
Q2001		2SC4081/QRS/-X	TRANSISTOR
		or 2SD1819A/QRS/-X	TRANSISTOR
		or 2PC4081/R/-X	TRANSISTOR
Q2002		2SC4081/QRS/-X	TRANSISTOR
		or 2PC4081/R/-X	TRANSISTOR
		or 2SD1819A/QRS/-X	TRANSISTOR
Q2003		DTA144WU	DIGI TRANSISTOR
		or PDA144WU	DIGI TRANSISTOR
		or RN2309	TRANSISTOR
		or UN511E	DIGI TRANSISTOR

#	△ REF No.	PART No.	PART NAME, DESCRIPTION
Q2051		2SC4081/QRS/-X	TRANSISTOR
		or 2PC4081/R/-X	TRANSISTOR
		or 2SD1819A/QRS/-X	TRANSISTOR
Q2052		2SA1576A/QR/-X	TRANSISTOR
		or 2SB1218A/QR/-X	TRANSISTOR
		or 2PA1576/R/-X	TRANSISTOR
Q2053		DTC144WU	DIGI TRANSISTOR
		or PDTC144WU	DIGI TRANSISTOR
		or RN1309	DIGI TRANSISTOR
		or UN521E	DIGI TRANSISTOR
Q2054		2SA1576A/QR/-X	TRANSISTOR
		or 2PA1576/R/-X	TRANSISTOR
		or 2SB1218A/QR/-X	TRANSISTOR
Q2055		DTC144WU	DIGI TRANSISTOR
		or PDTC144WU	DIGI TRANSISTOR
		or RN1309	DIGI TRANSISTOR
		or UN521E	DIGI TRANSISTOR
Q2061		2SC4081/QRS/-X	TRANSISTOR,J780MS/J781MS
		or 2PC4081/R/-X	TRANSISTOR,J780MS/J781MS
		or 2SD1819A/QRS/-X	TRANSISTOR,J780MS/J781MS
Q2062		2SA1576A/QR/-X	TRANSISTOR,J780MS/J781MS
		or 2PA1576/R/-X	TRANSISTOR,J780MS/J781MS
		or 2SB1218A/QR/-X	TRANSISTOR,J780MS/J781MS
Q2063		DTC144WU	DIGI TRANSISTOR,J780MS/J781MS
		or PDTC144WU	DIGI TRANSISTOR,J780MS/J781MS
		or RN1309	DIGI TRANSISTOR,J780MS/J781MS
		or UN521E	DIGI TRANSISTOR,J780MS/J781MS
Q2251		DTA144WU	DIGI TRANSISTOR
		or PDA144WU	DIGI TRANSISTOR
		or RN2309	TRANSISTOR
		or UN511E	DIGI TRANSISTOR
Q2252		DTC114EU	DIGI TRANSISTOR
		or PDTC114EU	DIGI TRANSISTOR
		or RN1302	DIGI TRANSISTOR
		or UN5211	DIGI TRANSISTOR
Q3001		2SD1819A/QRS/-X	TRANSISTOR
		or 2PC4081/R/-X	TRANSISTOR
		or 2SC4081/QRS/-X	TRANSISTOR
Q3003		PTZ-NV16	PHOTO TRANSISTOR
		or PTZ-NV16A	PHOTO TRANSISTOR
Q3004		2SD1819A/QRS/-X	TRANSISTOR
		or 2PC4081/R/-X	TRANSISTOR
		or 2SC4081/QRS/-X	TRANSISTOR
Q3005		2SD1819A/QRS/-X	TRANSISTOR
		or 2SC4081/QRS/-X	TRANSISTOR
		or 2PC4081/R/-X	TRANSISTOR
Q3007		UN521E	DIGI TRANSISTOR
		or RN1309	DIGI TRANSISTOR
		or DTC144WU	DIGI TRANSISTOR
		or PDTC144WU	DIGI TRANSISTOR
Q4001		UN5211	DIGI TRANSISTOR
		or DTC114EU	DIGI TRANSISTOR
		or PDTC114EU	DIGI TRANSISTOR
		or RN1302	DIGI TRANSISTOR
Q5101		2SK2632-CB14	POWER MOS FET
		or 2SK2129	POWER MOS FET
		or 2SK2129-LT	POWER MOS FET
		or 2SK2632	POWER MOS FET
Q5102		2SD2144S/UV/-T	TRANSISTOR
Q5302		2SD2375/QP/	TRANSISTOR
Q5303		2SD1819A/RS/-X	TRANSISTOR

#	△	REF No.	PART No.	PART NAME, DESCRIPTION	#	△	REF No.	PART No.	PART NAME, DESCRIPTION
			or 2PC4081/R/-X	TRANSISTOR	D2101		MTZJ8.2C	ZENER DIODE	
			or 2SC4081/RS/-X	TRANSISTOR	D3001		LNB2301L01V1	LE DIODE	
Q5304			2SC3616/ML/-T	TRANSISTOR	D3002		1SS133	DIODE	
Q5305			DTA114EU	DIGI TRANSISTOR			or 1SS270A	DIODE	
			or PDTA114EU	DIGI TRANSISTOR	D3003		RD39ES/B3/-T2	ZENER DIODE	
			or RN2302	TRANSISTOR			or MTZJ39C	ZENER DIODE	
			or UN5111	DIGI TRANSISTOR	D3004		11ES2	DIODE	
Q5306			DTC114EU	DIGI TRANSISTOR			or 1A3G	DIODE	
			or PDTC114EU	DIGI TRANSISTOR	D3005		11ES2	DIODE	
			or RN1302	DIGI TRANSISTOR			or 1A3G	DIODE	
			or UN5211	DIGI TRANSISTOR	D3008		1SS133	DIODE	
Q5308			2SA1576A/RS/-X	TRANSISTOR	D4001		QUY153-050Y	IM BUS WIRE	
Q6030			2SB1218A/RS/-X	TRANSISTOR	D4002		QUY153-050Y	IM BUS WIRE	
Q6031			DTC114EU	DIGI TRANSISTOR	D5001		S1WB/A/60-4102	BRIDGE DIODE	
			or PDTC114EU	DIGI TRANSISTOR			or S1WB(A)60F4072X	BRIDGE DIODE	
			or RN1302	DIGI TRANSISTOR			or S1WB/A/60-X	BRIDGE DIODE	
			or UN5211	DIGI TRANSISTOR	D5101		AU01	FR DIODE	
Q6032			DTC114EU	DIGI TRANSISTOR			or ERA18-04-T2	FR DIODE	
			or PDTC114EU	DIGI TRANSISTOR			or 10ELS4	FR DIODE	
			or RN1302	DIGI TRANSISTOR			or 1SR153-400-T2	FR DIODE	
			or UN5211	DIGI TRANSISTOR	D5102		AU01	FR DIODE	
Q7001			DTA143TU	DIGI TRANSISTOR			or ERA18-04-T2	FR DIODE	
Q7002			DTA143TU	DIGI TRANSISTOR			or 10ELS4	FR DIODE	
Q7003			DTA143TU	DIGI TRANSISTOR			or 1SR153-400-T2	FR DIODE	
Q7004			DTA143TU	DIGI TRANSISTOR	D5103		1SS133	DIODE	
Q7005			DTA143TU	DIGI TRANSISTOR			or 1SS270A	DIODE	
Q7101			2SB1218A/QRS/-X	TRANSISTOR	D5105		1SS133	DIODE	
			or 2SA1576A/QRS/-X	TRANSISTOR			or 1SS270A	DIODE	
			or 2PA1576/R/-X	TRANSISTOR	D5203		AU01Z	FR DIODE	
Q7102			DTC144WU	DIGI TRANSISTOR			or 10ELS2	FR DIODE	
			or PDTC144WU	DIGI TRANSISTOR	D5204		AU01Z	FR DIODE	
			or UN521E	DIGI TRANSISTOR			or 10ELS2	FR DIODE	
			or RN1309	DIGI TRANSISTOR	D5208		RK14LF-B2	BARRIER DIODE	
Q7106			2SA1576A/QRS/-X	TRANSISTOR			or 21DQ04	BARRIER DIODE	
			or 2PA1576/R/-X	TRANSISTOR			or SB240-F26	SB DIODE	
Q7107			DTA144WU	DIGI TRANSISTOR	D5210		AU01Z	FR DIODE	
			or PDTA144WU	DIGI TRANSISTOR			or PG104RS	FR DIODE	
			or RN2309	TRANSISTOR			or 1SR153-400-T2	FR DIODE	
			or UN511E	DIGI TRANSISTOR			or 10ELS2	FR DIODE	
Q7108			DTC144WU	DIGI TRANSISTOR			or ERA18-02-T2	FR DIODE	
			or PDTC144WU	DIGI TRANSISTOR	D5301		MTZJ15C	ZENER DIODE	
			or RN1309	DIGI TRANSISTOR			or RD15ES/B3/-T2	ZENER DIODE	
			or UN521E	DIGI TRANSISTOR	D5302		1SS133	DIODE	
Q7109			2SC4081/QRS/-X	TRANSISTOR			or 1SS270A	DIODE	
			or 2PC4081/R/-X	TRANSISTOR	D5303		RD5.1JS/B2/-T2	ZENER DIODE	
			or 2SD1819A/QRS/-X	TRANSISTOR			or MA4051N/M/-T2	ZENER DIODE	
Q7110			2SC4081/QRS/-X	TRANSISTOR	D5304		1SS133	DIODE	
			or 2SD1819A/QRS/-X	TRANSISTOR			or 1SS270A	DIODE	
			or 2PC4081/R/-X	TRANSISTOR	D5305		AK04	DIODE	
Q7201			2SC1317/RS/-T	TRANSISTOR,J680MS/J780MS/J781MS			or 1S4	SB DIODE	
D6			MTZJ5.6C	ZENER DIODE			or 11EQS04	SB DIODE	
			or RD5.6ES/B3/-T2	ZENER DIODE	D5307		QUY160-100Y	IM BUS WIRE	
D201			QRE141J-101Y	RESISTOR,J680MS/J780MS/J781MS 100Ω,1/4W	D5308		MTZJ11C	ZENER DIODE	
			1SS133	DIODE,J580MS			or RD11ES/B3/-T2	ZENER DIODE	
			or 1SS270A	DIODE,J580MS	D5316		QUY160-100Y	IM BUS WIRE	
D202			QRE141J-101Y	RESISTOR,J680MS/J780MS/J781MS 100Ω,1/4W	D6002		HZ30-2L-T2	ZENER DIODE	
			1SS133	DIODE,J580MS			or HZ30-2LTD	Z DIODE (M)	
			or 1SS270A	DIODE,J580MS	D6701		1SS133	DIODE	
D203			QRE141J-101Y	RESISTOR,J680MS/J780M1/J781MS 100Ω,1/4W	D7101		1SS133	DIODE	
			1SS133	DIODE,J580MS	D7102		1SS133	DIODE	
			or 1SS270A	DIODE,J580MS	D7103		QUY160-100Y	IM BUS WIRE	

#	△ REF No.	PART No.	PART NAME, DESCRIPTION	#	△ REF No.	PART No.	PART NAME, DESCRIPTION
D7105		MTZJ12C	ZENER DIODE	R2004		NRSA02J-332X	MG RESISTOR 3.3kΩ,1/10W
		or RD12ES/B3/-T2	ZENER DIODE	R2006		NRSA02J-393X	MG RESISTOR,J780MS/J781MS 39kΩ,1/10W
D7106		MTZJ12C	ZENER DIODE	R2007		NRSA02J-393X	MG RESISTOR 39kΩ,1/10W
R1		NRSA02J-682X	MG RESISTOR 6.8kΩ,1/10W	R2009		NRSA02J-123X	MG RESISTOR,J780MS/J781MS 12kΩ,1/10W
R2		NRSA02J-152X	MG RESISTOR 1.5kΩ,1/10W	R2010		NRSA02J-123X	MG RESISTOR 12kΩ,1/10W
R3		NRSA02J-222X	MG RESISTOR 2.2kΩ,1/10W	R2013		NRSA02J-682X	MG RESISTOR 6.8kΩ,1/10W
R5		NRSA02J-0R0X	MG RESISTOR 0Ω,1/10W	R2014		NRSA02J-224X	MG RESISTOR 220kΩ,1/10W
R6		NRSA02J-273X	MG RESISTOR 27kΩ,1/10W	R2015		NRSA02J-181X	MG RESISTOR 180Ω,1/10W
R7		NRSA02J-681X	MG RESISTOR 680Ω,1/10W	R2016		NRSA02J-393X	MG RESISTOR 39kΩ,1/10W
R8		QRE141J-101Y	RESISTOR 100Ω,1/4W	R2017		NRSA02J-183X	MG RESISTOR 18kΩ,1/10W
R9		QRE141J-101Y	RESISTOR 100Ω,1/4W	R2018		NRSA02J-472X	MG RESISTOR 4.7kΩ,1/10W
R12		QRE141J-101Y	RESISTOR 100Ω,1/4W	R2019		NRSA02J-472X	MG RESISTOR 4.7kΩ,1/10W
R21		NRSA02J-102X	MG RESISTOR 1kΩ,1/10W	R2053		NRSA02J-472X	MG RESISTOR 4.7kΩ,1/10W
R22		NRSA02J-102X	MG RESISTOR 1kΩ,1/10W	R2054		NRSA02J-123X	MG RESISTOR,J580MS/J680MS 12kΩ,1/10W
R33		NRSA02J-822X	MG RESISTOR 8.2kΩ,1/10W			NRSA02J-153X	MG RESISTOR,J780MS/J781MS 15kΩ,1/10W
R37		NRSA02J-0R0X	MG RESISTOR 0Ω,1/10W	R2055		NRSA02J-3R3X	MG RESISTOR 3.3Ω,1/10W
R46		NRSA02J-331X	MG RESISTOR 330Ω,1/10W	R2056		QRE141J-101Y	RESISTOR,J780MS/J781MS 100Ω,1/4W
R47		NRSA02J-821X	MG RESISTOR 820Ω,1/10W			QRE141J-820Y	RESISTOR,J580MS/J680MS 82Ω,1/4W
R48		NRSA02J-102X	MG RESISTOR 1kΩ,1/10W	R2057		NRSA02J-473X	MG RESISTOR 47kΩ,1/10W
R50		NRSA02J-102X	MG RESISTOR 1kΩ,1/10W	R2058		NRSA02J-183X	MG RESISTOR 18kΩ,1/10W
R72		NRSA02J-822X	MG RESISTOR 8.2kΩ,1/10W	R2059		NRSA02J-473X	MG RESISTOR 47kΩ,1/10W
R73		NRSA02J-122X	MG RESISTOR 1.2kΩ,1/10W	R2060		NRSA02J-183X	MG RESISTOR 18kΩ,1/10W
R77		NRSA02J-103X	MG RESISTOR 10kΩ,1/10W	R2061		NRSA63J-273X	MG RESISTOR,J780MS/J781MS 27kΩ,1/16W
R90		NRSA02J-391X	MG RESISTOR 390Ω,1/10W	R2062		NRSA63J-3R3X	MG RESISTOR,J780MS/J781MS 3.3Ω,1/16W
R92		NRSA02J-152X	MG RESISTOR 1.5kΩ,1/10W	R2063		QRE141J-151Y	RESISTOR,J780MS/J781MS 150Ω,1/4W
R93		NRSA02J-222X	MG RESISTOR 2.2kΩ,1/10W	R2064		NRSA63J-473X	MG RESISTOR,J780MS/J781MS 47kΩ,1/16W
R104		NRSA02J-682X	MG RESISTOR 6.8kΩ,1/10W	R2065		NRSA63J-183X	MG RESISTOR,J780MS/J781MS 18kΩ,1/16W
R115		NRSA02J-102X	MG RESISTOR 1kΩ,1/10W	R2201		QRE141J-151Y	RESISTOR 150Ω,1/4W
R116		NRSA02J-681X	MG RESISTOR 680Ω,1/10W	R2206		NRSA02J-101X	MG RESISTOR 100Ω,1/10W
R202		NRSA02J-103X	MG RESISTOR 10kΩ,1/10W	R2207		NRSA02J-332X	MG RESISTOR 3.3kΩ,1/10W
R203		NRSA02J-103X	MG RESISTOR,J580MS 10kΩ,1/10W	R2218		NRSA02J-393X	MG RESISTOR,J780MS/J781MS 39kΩ,1/10W
R204		NRSA02J-103X	MG RESISTOR,J580MS 10kΩ,1/10W	R2219		NRSA02J-393X	MG RESISTOR 39kΩ,1/10W
R209		NRSA02J-512X	MG RESISTOR,J680MS/J780M1/J781MS 5.1kΩ,1/10W	R2223		NRSA02J-123X	MG RESISTOR,J780MS/J781MS 12kΩ,1/10W
R210		NRSA02J-182X	MG RESISTOR,J680MS/J780M1/J781MS 1.8kΩ,1/10W	R2224		QRE141J-123Y	RESISTOR 12kΩ,1/4W
R211		NRSA02J-562X	MG RESISTOR,J680MS/J780M1/J781MS 5.6kΩ,1/10W	R2226		NRSA02J-123X	MG RESISTOR 12kΩ,1/10W
R213		NRSA02J-222X	MG RESISTOR,J580MS 2.2kΩ,1/10W	R2227		QRE141J-123Y	RESISTOR 12kΩ,1/4W
		NRSA02J-0R0X	MG RESISTOR,J680MS/J780M1/J781MS 0Ω,1/10W	R2228		NRSA02J-103X	MG RESISTOR 10kΩ,1/10W
R216		NRSA02J-103X	MG RESISTOR 10kΩ,1/10W	R2229		NRSA02J-563X	MG RESISTOR 56kΩ,1/10W
R220		NRSA02J-0R0X	MG RESISTOR,J580MS 0Ω,1/10W	R2251		NRSA02J-471X	MG RESISTOR 470Ω,1/10W
R224		NRSA02J-681X	MG RESISTOR 680Ω,1/10W	R3013		NRSA02J-472X	MG RESISTOR 4.7kΩ,1/10W
R225		QUY160-100Y	IM BUS WIRE	R3014		NRSA02J-472X	MG RESISTOR 4.7kΩ,1/10W
R301		NRSA02J-273X	MG RESISTOR 27kΩ,1/10W	R3015		NRSA02J-472X	MG RESISTOR 4.7kΩ,1/10W
R302		NRSA02J-124X	MG RESISTOR 120kΩ,1/10W	R3016		NRSA02J-102X	MG RESISTOR 1kΩ,1/10W
R303		NRSA02J-273X	MG RESISTOR 27kΩ,1/10W	R3018		NRSA02J-102X	MG RESISTOR 1kΩ,1/10W
R304		NRSA02J-682X	MG RESISTOR 6.8kΩ,1/10W	R3019		NRSA02J-682X	MG RESISTOR 6.8kΩ,1/10W
R305		NRSA02J-473X	MG RESISTOR 47kΩ,1/10W	R3020		NRSA02J-472X	MG RESISTOR 4.7kΩ,1/10W
R306		NRSA02J-273X	MG RESISTOR 27kΩ,1/10W	R3021		NRSA02J-472X	MG RESISTOR 4.7kΩ,1/10W
R307		QRE141J-222Y	RESISTOR 2.2kΩ,1/4W	R3022		NRSA02J-472X	MG RESISTOR 4.7kΩ,1/10W
R308		NRSA02J-222X	MG RESISTOR 2.2kΩ,1/10W	R3026		NRSA02J-0R0X	MG RESISTOR 0Ω,1/10W
R309		NRSA02J-821X	MG RESISTOR 820Ω,1/10W	R3027		NRSA02J-0R0X	MG RESISTOR 0Ω,1/10W
R310		NRSA02J-223X	MG RESISTOR 22kΩ,1/10W	R3028		NRSA02J-0R0X	MG RESISTOR 0Ω,1/10W
R311		NRSA02J-392X	MG RESISTOR 3.9kΩ,1/10W	R3029		QRE141J-472Y	RESISTOR 4.7kΩ,1/4W
R312		NRSA02J-272X	MG RESISTOR 2.7kΩ,1/10W	R3030		NRSA02J-472X	MG RESISTOR 4.7kΩ,1/10W
R313		NRSA02J-223X	MG RESISTOR 22kΩ,1/10W	R3031		NRSA02J-472X	MG RESISTOR 4.7kΩ,1/10W
R314		NRVA02D-243X	CMF RESISTOR 24kΩ,1/10W	R3032		NRSA02J-472X	MG RESISTOR 4.7kΩ,1/10W
R315		NRSA02J-564X	MG RESISTOR 560kΩ,1/10W	R3033		NRSA02J-0R0X	MG RESISTOR 0Ω,1/10W
R316		NRSA02J-224X	MG RESISTOR 220kΩ,1/10W	R3034		QUY160-100Y	IM BUS WIRE
R329		NRSA02J-0R0X	MG RESISTOR 0Ω,1/10W	R3035		NRSA02J-0R0X	MG RESISTOR 0Ω,1/10W
R2001		QRE141J-681Y	RESISTOR 680Ω,1/4W	R3036		NRSA02J-0R0X	MG RESISTOR 0Ω,1/10W
R2002		NRSA02J-272X	MG RESISTOR 2.7kΩ,1/10W	R3037		NRSA02J-0R0X	MG RESISTOR 0Ω,1/10W
R2003		NRSA02J-101X	MG RESISTOR 100Ω,1/10W	R3038		NRSA02J-0R0X	MG RESISTOR 0Ω,1/10W

#	△	REF No.	PART No.	PART NAME, DESCRIPTION	#	△	REF No.	PART No.	PART NAME, DESCRIPTION
R3039			QRE141J-102Y	RESISTOR 1kΩ,1/4W	R3219			NRSA02J-472X	MG RESISTOR 4.7kΩ,1/10W
R3041			NRSA02J-472X	MG RESISTOR 4.7kΩ,1/10W	R3220			NRSA02J-104X	MG RESISTOR 100kΩ,1/10W
R3042			QRE141J-102Y	RESISTOR 1kΩ,1/4W	R3222			NRSA02J-103X	MG RESISTOR 10kΩ,1/10W
R3044			NRSA02J-472X	MG RESISTOR,J680MS/J780M1/J781MS 4.7kΩ,1/10W	R3223			NRSA02J-152X	MG RESISTOR 1.5kΩ,1/10W
R3047			NRSA02J-0R0X	MG RESISTOR 0Ω,1/10W	R3224			NRSA02J-152X	MG RESISTOR 1.5kΩ,1/10W
R3048			NRSA63J-0R0X	MG RESISTOR 0Ω,1/16W	R3225			NRSA02J-103X	MG RESISTOR 10kΩ,1/10W
R3049			NRSA02J-101X	MG RESISTOR 100Ω,1/10W	R3226			NRSA02J-103X	MG RESISTOR 10kΩ,1/10W
R3050			NRSA02J-101X	MG RESISTOR 100Ω,1/10W	R3227			NRSA02J-103X	MG RESISTOR 10kΩ,1/10W
R3052			NRSA02J-471X	MG RESISTOR 470Ω,1/10W	R3229			NRSA02J-105X	MG RESISTOR 1MΩ,1/10W
R3053			NRSA02J-471X	MG RESISTOR 470Ω,1/10W	R3230			NRSA02J-472X	MG RESISTOR 4.7kΩ,1/10W
R3054			NRSA02J-0R0X	MG RESISTOR 0Ω,1/10W	R3231			NRSA02J-102X	MG RESISTOR 1kΩ,1/10W
R3055			NRSA02J-102X	MG RESISTOR 1kΩ,1/10W	R3232			NRSA02J-472X	MG RESISTOR 4.7kΩ,1/10W
R3056			NRSA02J-472X	MG RESISTOR,J780MS/J781MS 4.7kΩ,1/10W	R3234			QRE141J-103Y	RESISTOR 10kΩ,1/4W
R3057			NRSA02J-472X	MG RESISTOR,J780MS/J781MS 4.7kΩ,1/10W	R3235			NRSA02J-332X	MG RESISTOR 3.3kΩ,1/10W
R3058			NRSA02J-102X	MG RESISTOR 1kΩ,1/10W	R3236			NRSA02J-332X	MG RESISTOR 3.3kΩ,1/10W
R3059			NRSA02J-102X	MG RESISTOR 1kΩ,1/10W	R3240			NRSA02J-105X	MG RESISTOR 1MΩ,1/10W
R3060			NRSA02J-102X	MG RESISTOR 1kΩ,1/10W	R3244			NRSA02J-333X	MG RESISTOR,J780MS/J781MS 33kΩ,1/10W
R3061			NRSA02J-102X	MG RESISTOR 1kΩ,1/10W	R3245			NRSA02J-333X	MG RESISTOR,J780MS/J781MS 33kΩ,1/10W
R3062			NRSA02J-103X	MG RESISTOR 10kΩ,1/10W	R3251			NRSA02J-103X	MG RESISTOR,J780MS/J781MS 10kΩ,1/10W
R3066			NRSA02J-102X	MG RESISTOR 1kΩ,1/10W	R4003			NRSA02J-561X	MG RESISTOR 560Ω,1/10W
R3069			NRSA02J-101X	MG RESISTOR 100Ω,1/10W	R4004			NRSA02J-561X	MG RESISTOR 560Ω,1/10W
R3071			NRSA02J-103X	MG RESISTOR 10kΩ,1/10W	R4005			NRSA02J-562X	MG RESISTOR 5.6kΩ,1/10W
R3072			NRSA02J-102X	MG RESISTOR 1kΩ,1/10W	R4007			QRE141J-102Y	RESISTOR 1kΩ,1/4W
R3073			NRSA02J-102X	MG RESISTOR 1kΩ,1/10W	R4008			NRSA02J-0R0X	MG RESISTOR 0Ω,1/10W
R3074			QRE141J-102Y	RESISTOR 1kΩ,1/4W	R4009			NRSA02J-102X	MG RESISTOR 1kΩ,1/10W
R3075			NRSA02J-101X	MG RESISTOR 100Ω,1/10W	R4010			NRSA02J-102X	MG RESISTOR 1kΩ,1/10W
R3076			NRSA02J-101X	MG RESISTOR 100Ω,1/10W	R4011			NRSA02J-472X	MG RESISTOR 4.7kΩ,1/10W
R3077			NRSA02J-0R0X	MG RESISTOR 0Ω,1/10W	R4012			NRSA02J-222X	MG RESISTOR 2.2kΩ,1/10W
R3078			NRSA02J-0R0X	MG RESISTOR 0Ω,1/10W	R4013			NRSA02J-102X	MG RESISTOR 1kΩ,1/10W
R3079			NRSA02J-102X	MG RESISTOR 1kΩ,1/10W	R4014			NRSA02J-0R0X	MG RESISTOR 0Ω,1/10W
R3080			NRSA02J-472X	MG RESISTOR,J780MS/J781MS 4.7kΩ,1/10W	R4015			NRSA02J-562X	MG RESISTOR 5.6kΩ,1/10W
R3081			NRSA02J-102X	MG RESISTOR 1kΩ,1/10W	R4017			NRSA02J-102X	MG RESISTOR 1kΩ,1/10W
R3083			NRSA02J-102X	MG RESISTOR 1kΩ,1/10W	R4018			NRSA02J-102X	MG RESISTOR 1kΩ,1/10W
R3085			NRSA02J-102X	MG RESISTOR 1kΩ,1/10W	R4019			NRSA02J-103X	MG RESISTOR 10kΩ,1/10W
R3086			NRSA02J-102X	MG RESISTOR 1kΩ,1/10W	R4020			QRE141J-103Y	RESISTOR 10kΩ,1/4W
R3087			NRSA02J-0R0X	MG RESISTOR 0Ω,1/10W	R4021			NRSA02J-103X	MG RESISTOR 10kΩ,1/10W
R3088			QUY160-100Y	IM BUS WIRE	R5101			QRE141J-334Y	RESISTOR 330kΩ,1/4W
R3089			NRSA02J-0R0X	MG RESISTOR 0Ω,1/10W	R5102			QRE141J-334Y	RESISTOR 330kΩ,1/4W
R3093			QUY160-100Y	IM BUS WIRE	R5103			QRE141J-683Y	RESISTOR 68kΩ,1/4W
R3094			NRSA02J-102X	MG RESISTOR 1kΩ,1/10W	R5104			QRG02GJ-683	OMF RESISTOR 68kΩ,2W
R3095			NRSA02J-102X	MG RESISTOR 1kΩ,1/10W	R5106			QRT01DJ-R39X	MF RESISTOR 0.39Ω,1W
R3104			NRSA02J-0R0X	MG RESISTOR 0Ω,1/10W	R5107			QRE121J-331Y	RESISTOR 330Ω,1/2W
R3105			NRSA02J-0R0X	MG RESISTOR 0Ω,1/10W	R5108			NRSA02J-152X	MG RESISTOR 1.5kΩ,1/10W
R3106			QUY160-100Y	IM BUS WIRE	R5109			QRE141J-681Y	RESISTOR 680Ω,1/4W
R3201			NRSA02J-103X	MG RESISTOR 10kΩ,1/10W	R5110			NRSA02J-224X	MG RESISTOR 220kΩ,1/10W
R3202			NRSA02J-472X	MG RESISTOR 4.7kΩ,1/10W	R5111			NRSA02J-681X	MG RESISTOR 680Ω,1/10W
R3203			NRSA02J-103X	MG RESISTOR 10kΩ,1/10W	R5112			NRSA02J-221X	MG RESISTOR 220Ω,1/10W
R3204			NRSA02J-222X	MG RESISTOR 2.2kΩ,1/10W	R5301			NRSA02J-472X	MG RESISTOR 4.7kΩ,1/10W
R3205			QRE141J-181Y	RESISTOR 180Ω,1/4W	R5302			NRSA02J-102X	MG RESISTOR 1kΩ,1/10W
R3207			NRSA02J-183X	MG RESISTOR 18kΩ,1/10W	R5303			NRSA02J-122X	MG RESISTOR 1.2kΩ,1/10W
R3208			QRE141J-181Y	RESISTOR 180Ω,1/4W	R5304			NRSA02J-471X	MG RESISTOR 470Ω,1/10W
R3209			QRE141J-273Y	RESISTOR 27kΩ,1/4W	R5305			NRSA02J-102X	MG RESISTOR 1kΩ,1/10W
R3210			NRSA02J-181X	MG RESISTOR 180Ω,1/10W	R5306			NRSA02J-471X	MG RESISTOR 470Ω,1/10W
R3211			NRSA02J-273X	MG RESISTOR 27kΩ,1/10W	R5308			NRSA02J-471X	MG RESISTOR 470Ω,1/10W
R3212			NRSA02J-474X	MG RESISTOR 470kΩ,1/10W	R5309			NRSA02J-103X	MG RESISTOR 10kΩ,1/10W
R3213			NRSA02J-334X	MG RESISTOR 330kΩ,1/10W	R5310			NRSA02J-471X	MG RESISTOR 470Ω,1/10W
R3214			NRSA02J-103X	MG RESISTOR 10kΩ,1/10W	R5311			NRSA02J-473X	MG RESISTOR 47kΩ,1/10W
R3215			NRSA02J-103X	MG RESISTOR 10kΩ,1/10W	R5312			QRE141J-332Y	RESISTOR 3.3kΩ,1/4W
R3216			NRSA02J-103X	MG RESISTOR 10kΩ,1/10W	R5313			NRSA02D-332X	MG RESISTOR 3.3kΩ,1/10W
R3217			NRSA02J-562X	MG RESISTOR 5.6kΩ,1/10W	R5314			NRSA02J-102X	MG RESISTOR 1kΩ,1/10W
R3218			QRE141J-472Y	RESISTOR 4.7kΩ,1/4W	R5316			NRSA02D-123X	MG RESISTOR 12kΩ,1/10W

#	△ REF No.	PART No.	PART NAME, DESCRIPTION	#	△ REF No.	PART No.	PART NAME, DESCRIPTION
R5317		NRSA02J-473X	MG RESISTOR 47kΩ,1/10W	R7135		NQR0148-002X	FERRITE BEAD
R5320		NRSA02J-273X	MG RESISTOR 27kΩ,1/10W	R7136		NQR0148-002X	FERRITE BEAD
R5321		QRE141J-273Y	RESISTOR 27kΩ,1/4W	R7137		NRSA02J-102X	MG RESISTOR 1kΩ,1/10W
R6020		NRSA02J-102X	MG RESISTOR 1kΩ,1/10W	R7139		QRE141J-101Y	RESISTOR 100Ω,1/4W
R6021		NRSA02J-102X	MG RESISTOR 1kΩ,1/10W	R7140		NRSA02J-101X	MG RESISTOR 100Ω,1/10W
R6030		NRSA02J-102X	MG RESISTOR 1kΩ,1/10W	R7142		NRSA02J-681X	MG RESISTOR 680Ω,1/10W
R6031		NRSA02J-271X	MG RESISTOR 270Ω,1/10W	R7144		NRSA02J-681X	MG RESISTOR 680Ω,1/10W
R6032		NRSA02J-183X	MG RESISTOR 18kΩ,1/10W	R7146		NRSA02J-102X	MG RESISTOR 1kΩ,1/10W
R6033		NRSA02J-183X	MG RESISTOR 18kΩ,1/10W	R7147		NRSA02J-222X	MG RESISTOR 2.2kΩ,1/10W
R6056		NRSA02J-0R0X	MG RESISTOR 0Ω,1/10W	R7148		NRSA02J-222X	MG RESISTOR 2.2kΩ,1/10W
R6702		NRSA02J-182X	MG RESISTOR 1.8kΩ,1/10W	R7149		NRSA02J-101X	MG RESISTOR 100Ω,1/10W
R6707		NRSA02J-220X	MG RESISTOR 22Ω,1/10W	R7150		NRSA02J-101X	MG RESISTOR 100Ω,1/10W
R6708		QUY153-050Y	IM BUS WIRE	R7160		NRSA02J-331X	MG RESISTOR,J780MS/J781MS 330Ω,1/10W
R6709		QUY153-050Y	IM BUS WIRE	R7161		NRSA02J-101X	MG RESISTOR,J780MS/J781MS 100Ω,1/10W
R6710		NRSA02J-0R0X	MG RESISTOR 0Ω,1/10W	R7162		NRSA02J-331X	MG RESISTOR,J780MS/J781MS 330Ω,1/10W
R6711		NRSA02J-684X	MG RESISTOR 680kΩ,1/10W	R7163		NRSA02J-750X	MG RESISTOR,J780MS/J781MS 75Ω,1/10W
R6712		NRSA02J-102X	MG RESISTOR 1kΩ,1/10W	R7202		QRE141J-221Y	RESISTOR,J680MS/J780M1/J781MS 220Ω,1/4W
R6713		NRSA02J-123X	MG RESISTOR 12kΩ,1/10W	R7203		NRSA02J-472X	MG RESISTOR,J680MS/J780M1/J781MS 4.7kΩ,1/10W
R6714		NRSA02J-102X	MG RESISTOR 1kΩ,1/10W	R7204		QRE123J-100X	RESISTOR,J680MS/J780M1/J781MS 10Ω,1/2W
R6715		NRSA02J-123X	MG RESISTOR 12kΩ,1/10W	R7205		NRSA02J-223X	MG RESISTOR 22kΩ,1/10W
R6716		NRSA02J-100X	MG RESISTOR 10Ω,1/10W	R7206		NRSA02J-223X	MG RESISTOR 22kΩ,1/10W
R6719		NRSA02J-103X	MG RESISTOR 10kΩ,1/10W	B5		NRSA02J-0R0X	MG RESISTOR 0Ω,1/10W
R6720		NRSA02J-562X	MG RESISTOR 5.6kΩ,1/10W	B22		NRSA02J-0R0X	MG RESISTOR 0Ω,1/10W
R6721		NRSA02J-562X	MG RESISTOR 5.6kΩ,1/10W	B24		NRSA02J-0R0X	MG RESISTOR 0Ω,1/10W
R7001		NRSA02J-331X	MG RESISTOR 330Ω,1/10W	B28		NRSA02J-0R0X	MG RESISTOR 0Ω,1/10W
R7015		NRSA02J-0R0X	MG RESISTOR 0Ω,1/10W	B71		NRSA02J-0R0X	MG RESISTOR 0Ω,1/10W
R7020		NRSA02J-103X	MG RESISTOR 10kΩ,1/10W	B204		NRSA02J-0R0X	MG RESISTOR,J680MS/J780M1/J781MS 0Ω,1/10W
R7021		NRSA02J-122X	MG RESISTOR 1.2kΩ,1/10W	B2051		NRSA02J-0R0X	MG RESISTOR,J580MS/J680MS 0Ω,1/10W
R7022		NRSA02J-182X	MG RESISTOR 1.8kΩ,1/10W	B3002		QUY153-050Y	IM BUS WIRE
R7023		NRSA02J-222X	MG RESISTOR 2.2kΩ,1/10W	B5302		QUY153-050Y	IM BUS WIRE
R7024		NRSA02J-272X	MG RESISTOR 2.7kΩ,1/10W	B6701		NRSA02J-0R0X	MG RESISTOR 0Ω,1/10W
R7025		NRSA02J-472X	MG RESISTOR,J680MS/J780M1/J781MS 4.7kΩ,1/10W	B7002		NRSA02J-0R0X	MG RESISTOR,J580MS 0Ω,1/10W
R7030		NRSA02J-103X	MG RESISTOR 10kΩ,1/10W	B7003		NRSA02J-0R0X	MG RESISTOR,J680MS/J780M1/J781MS 0Ω,1/10W
R7031		NRSA02J-122X	MG RESISTOR 1.2kΩ,1/10W	B7005		NRSA02J-0R0X	MG RESISTOR,J580MS 0Ω,1/10W
R7032		NRSA02J-182X	MG RESISTOR 1.8kΩ,1/10W	B7006		NRSA02J-0R0X	MG RESISTOR,J580MS 0Ω,1/10W
R7033		NRSA02J-222X	MG RESISTOR 2.2kΩ,1/10W	B7008		NRSA02J-0R0X	MG RESISTOR,J680MS 0Ω,1/10W
R7034		NRSA02J-272X	MG RESISTOR,J680MS/J780M1/J781MS 2.7kΩ,1/10W	B7009		NRSA02J-0R0X	MG RESISTOR 0Ω,1/10W
		NRSA02J-0R0X	MG RESISTOR,J580MS 0Ω,1/10W	B7118		NRSA02J-0R0X	MG RESISTOR 0Ω,1/10W
R7035		NRSA02J-472X	MG RESISTOR,J680MS/J780M1/J781MS 4.7kΩ,1/10W	B7120		NRSA02J-0R0X	MG RESISTOR 0Ω,1/10W
R7036		NRSA02J-682X	MG RESISTOR,J680MS/J780M1/J781MS 6.8kΩ,1/10W	C1		NCB21HK-103X	CAPACITOR 0.01μF,50V
R7037		NRSA02J-563X	MG RESISTOR 56kΩ,1/10W	C2		NCB21HK-103X	CAPACITOR 0.01μF,50V
R7101		NRSA63J-473X	MG RESISTOR 47kΩ,1/16W	C3		NCB21HK-103X	CAPACITOR 0.01μF,50V
R7102		NRSA63J-102X	MG RESISTOR 1kΩ,1/16W	C4		NCB21HK-103X	CAPACITOR 0.01μF,50V
R7103		NRSA02J-750X	MG RESISTOR 75Ω,1/10W	C5		QEKJ0JM-227	E CAPACITOR 220μF,6.3V
R7105		NRSA02J-331X	MG RESISTOR 330Ω,1/10W	C6		NCB21EK-104X	CAPACITOR 0.1μF,25V
R7107		NRSA02J-331X	MG RESISTOR 330Ω,1/10W	C8		NCB21EK-473X	CAPACITOR 0.047μF,25V
R7108		QRE141J-750Y	RESISTOR 75Ω,1/4W	C10		NDC21HJ-151X	CAPACITOR 150pF,50V
R7110		NRSA02J-221X	MG RESISTOR 220Ω,1/10W	C11		NCB21EK-104X	CAPACITOR 0.1μF,25V
R7111		NRSA02J-221X	MG RESISTOR 220Ω,1/10W	C12		NDC21HJ-7R0X	CAPACITOR 7pF,50V
R7112		NRSA02J-331X	MG RESISTOR 330Ω,1/10W	C14		NCB21EK-104X	CAPACITOR 0.1μF,25V
R7113		NRSA02J-750X	MG RESISTOR 75Ω,1/10W	C15		NCB21HK-103X	CAPACITOR 0.01μF,50V
R7114		NRSA02J-221X	MG RESISTOR 220Ω,1/10W	C16		NCB21EK-104X	CAPACITOR 0.1μF,25V
R7116		NRSA02J-221X	MG RESISTOR 220Ω,1/10W	C17		QEKJ1HM-335	E CAPACITOR 3.3μF,50V
R7117		QRE141J-750Y	RESISTOR 75Ω,1/4W	C19		QEKJ1HM-225	E CAPACITOR 2.2μF,50V
R7119		NQL402M-4R7X	COIL 4.7μH	C20		QEQF1HM-105	NP E CAPACITOR 1μF,50V
R7120		NQL402M-4R7X	COIL 4.7μH	C21		NCB21EK-104X	CAPACITOR 0.1μF,25V
R7122		NRSA02J-331X	MG RESISTOR 330Ω,1/10W	C22		QEKJ0JM-476	E CAPACITOR 47μF,6.3V
R7124		NRSA02J-331X	MG RESISTOR 330Ω,1/10W	C23		NCB21EK-104X	CAPACITOR 0.1μF,25V
R7131		NRSA02J-331X	MG RESISTOR 330Ω,1/10W	C24		NCB21EK-104X	CAPACITOR 0.1μF,25V
R7133		QRE141J-471Y	RESISTOR 470Ω,1/4W	C25		NDC21HJ-6R0X	CAPACITOR 6pF,50V
R7134		NRSA02J-471X	MG RESISTOR 470Ω,1/10W	C27		NCB21EK-223X	CAPACITOR 0.022μF,25V

#	△	REF No.	PART No.	PART NAME, DESCRIPTION	#	△	REF No.	PART No.	PART NAME, DESCRIPTION
C28			QEKJ1HM-335	E CAPACITOR 3.3μF,50V	C316			NCB21HK-103X	CAPACITOR 0.01μF,50V
C29			NCB21EK-333X	CAPACITOR 0.033μF,25V	C317			NCB21HK-681X	CAPACITOR 680pF,50V
C30			QEKJ1HM-474	E CAPACITOR 0.47μF,50V	C318			NCB21EK-223X	CAPACITOR 0.022μF,25V
C31			QEKJ0JM-476	E CAPACITOR 47μF,6.3V	C319			NCB21CK-105X	CAPACITOR 1μF,16V
C32			NCB21EK-104X	CAPACITOR 0.1μF,25V	C320			NCB21HK-103X	CAPACITOR 0.01μF,50V
C33			QEKJ1HM-225	E CAPACITOR 2.2μF,50V	C321			NDC21HG-301X	CAPACITOR 300pF,50V
C34			NCB21CK-224X	CAPACITOR 0.22μF,16V	C322			NCB21CK-474X	CAPACITOR 0.47μF,16V
C35			NCB21HK-103X	CAPACITOR 0.01μF,50V	C2001			QEKJ1HM-475	E CAPACITOR 4.7μF,50V
C36			QERF1EM-475	E CAPACITOR 4.7μF,25V	C2002			QEKJ1EM-106	E CAPACITOR 10μF,25V
C37			QEKJ1HM-105	E CAPACITOR 1μF,50V	C2003			QEKJ0JM-476	E CAPACITOR 47μF,6.3V
C38			QEKJ0JM-476	E CAPACITOR 47μF,6.3V	C2005			QEKJ1HM-475	E CAPACITOR 4.7μF,50V
C39			NCB21EK-104X	CAPACITOR 0.1μF,25V	C2006			NCB21HK-123X	CAPACITOR 0.012μF,50V
C40			QEKJ1EM-106	E CAPACITOR 10μF,25V	C2007			QEKJ1CM-226	E CAPACITOR 22μF,16V
C51			QEKJ1HM-105	E CAPACITOR,J780MS/J781MS 1μF,50V	C2008			QEKJ1HM-475	E CAPACITOR 4.7μF,50V
C53			NRSA02J-0R0X	MG RESISTOR 0Ω,1/10W	C2009			NCB21HK-102X	CAPACITOR 0.001μF,50V
C61			NCB21HK-103X	CAPACITOR 0.01μF,50V	C2010			NCB21HK-152X	CAPACITOR 0.0015μF,50V
C62			NCB21EK-104X	CAPACITOR 0.1μF,25V	C2011			QEKJ1HM-475	E CAPACITOR 4.7μF,50V
C64			NDC21HJ-220X	CAPACITOR 22pF,50V	C2012			QEKJ1HM-475	E CAPACITOR 4.7μF,50V
C65			QEKJ1HM-105	E CAPACITOR 1μF,50V	C2016			NDC21HJ-330X	CAPACITOR 33pF,50V
C69			NCB21HK-103X	CAPACITOR 0.01μF,50V	C2051			NCB21HK-331X	CAPACITOR 330pF,50V
C70			NCB21HK-103X	CAPACITOR 0.01μF,50V	C2052			QFLC1HJ-823Z	F CAPACITOR,J580MS/J680MS 0.082μF,50V
C79			NDC21HJ-390X	CAPACITOR 39pF,50V				QFLC1HJ-333Z	F CAPACITOR,J780MS/J781MS 0.033μF,50V
C81			NCB21HK-332X	CAPACITOR 0.0033μF,50V	C2053			NCB21HK-472X	CAPACITOR,J580MS/J680MS 0.0047μF,50V
C84			NDC21HJ-390X	CAPACITOR 39pF,50V				NCB21HK-332X	CAPACITOR,J780MS/J781MS 0.0033μF,50V
C92			NDC21HJ-330X	CAPACITOR 33pF,50V	C2054			NCB21EK-223X	CAPACITOR,J580MS/J680MS 0.022μF,25V
C94			NCB21HK-103X	CAPACITOR 0.01μF,50V				NCB21HK-103X	CAPACITOR,J780MS/J781MS 0.01μF,50V
C95			NCB21HK-103X	CAPACITOR 0.01μF,50V	C2055			QEKJ1EM-106	E CAPACITOR 10μF,25V
C106			NCB21HK-821X	CAPACITOR 820pF,50V	C2061			QFLC1HJ-333Z	F CAPACITOR,J780MS/J781MS 0.033μF,50V
C108			NDC21HJ-680X	CAPACITOR 68pF,50V	C2062			NCB31HK-332X	CAPACITOR,J780MS/J781MS 0.0033μF,50V
C109			NCB21CK-224X	CAPACITOR 0.22μF,16V	C2063			NCB31EK-103X	CAPACITOR,J780MS/J781MS 0.01μF,25V
C110			NDC21HJ-820X	CAPACITOR 82pF,50V	C2064			QEKJ1EM-106	E CAPACITOR,J780MS/J781MS 10μF,25V
C114			NDC21HJ-181X	CAPACITOR 180pF,50V	C2201			NCB21EK-104X	CAPACITOR 0.1μF,25V
C204			NCB21HK-103X	CAPACITOR,J580MS 0.01μF,50V	C2202			NCB21EK-333X	CAPACITOR 0.033μF,25V
			NDC21HJ-100X	CAPACITOR,J680MS/J780MS/J781MS 10pF,50V	C2203			QEKJ1EM-106	E CAPACITOR 10μF,25V
C206			NDC21HJ-330X	CAPACITOR 33pF,50V	C2204			NCB21HK-102X	CAPACITOR 0.001μF,50V
C207			NDC21HJ-330X	CAPACITOR 33pF,50V	C2205			QEKJ1HM-105	E CAPACITOR 1μF,50V
C209			NCB21CK-474X	CAPACITOR 0.47μF,16V	C2206			QEKJ1EM-106	E CAPACITOR 10μF,25V
C212			NCB21EK-104X	CAPACITOR,J680MS/J780MS/J781MS 0.1μF,25V	C2207			QEKJ1CM-476	E CAPACITOR 47μF,16V
C213			QERF1HM-475	E CAPACITOR,J680MS/J780MS/J781MS 4.7μF,50V	C2208			QEKJ1HM-475	E CAPACITOR 4.7μF,50V
C214			NCB21CK-224X	CAPACITOR 0.22μF,16V	C2215			QEKJ1HM-475	E CAPACITOR 4.7μF,50V
C215			NCB21CK-224X	CAPACITOR,J680MS/J780MS/J781MS 0.22μF,16V	C2217			QEKJ1EM-106	E CAPACITOR 10μF,25V
C216			QERF1AM-227	E CAPACITOR,J680MS/J780MS/J781MS 220μF,10V	C2219			QEKJ1EM-106	E CAPACITOR 10μF,25V
C217			NDC21HJ-560X	CAPACITOR 56pF,50V	C2220			QEKJ1HM-475	E CAPACITOR 4.7μF,50V
C218			NCB21CK-105X	CAPACITOR 1μF,16V	C2221			NCB21HK-103X	CAPACITOR 0.01μF,50V
C222			QERF1HM-105	E CAPACITOR 1μF,50V	C2222			QEKJ1HM-474	E CAPACITOR 0.47μF,50V
C226			QERF0JM-107	E CAPACITOR 100μF,6.3V	C2223			QEKJ1HM-474	E CAPACITOR 0.47μF,50V
C301			NDC21HJ-151X	CAPACITOR 150pF,50V	C2224			NCB21HK-103X	CAPACITOR 0.01μF,50V
C302			QEKJ1HM-225	E CAPACITOR 2.2μF,50V	C2225			QEKJ1HM-475	E CAPACITOR 4.7μF,50V
C303			NCB21HK-682X	CAPACITOR 0.0068μF,50V	C2226			QEKJ1EM-106	E CAPACITOR 10μF,25V
C304			NCB21HK-682X	CAPACITOR 0.0068μF,50V	C2227			NCB21EK-104X	CAPACITOR 0.1μF,25V
C305			NCB21HK-103X	CAPACITOR 0.01μF,50V	C2228			NCB21EK-104X	CAPACITOR 0.1μF,25V
C306			QEKJ0JM-476	E CAPACITOR 47μF,6.3V	C2251			QEKJ0JM-476	E CAPACITOR 47μF,6.3V
C307			NDC21HJ-151X	CAPACITOR 150pF,50V	C2252			QDYB1CM-103Y	CAPACITOR 0.01μF,16V
C308			NCB21HK-103X	CAPACITOR 0.01μF,50V	C2253			NCB21HK-103X	CAPACITOR 0.01μF,50V
C309			NCB21EK-104X	CAPACITOR 0.1μF,25V	C2254			NCB21HK-103X	CAPACITOR 0.01μF,50V
C310			NCB21HK-103X	CAPACITOR 0.01μF,50V	C2255			NDC21HJ-181X	CAPACITOR 180pF,50V
C311			NCB21HK-103X	CAPACITOR 0.01μF,50V	C3001			NCF21EZ-104X	CAPACITOR 0.1μF,25V
C312			NCB21HK-102X	CAPACITOR 0.001μF,50V	C3002			NCB21HK-103X	CAPACITOR 0.01μF,50V
C313			QERF1HM-474	E CAPACITOR 0.47μF,50V	C3003			QEKJ1HM-106	E CAPACITOR 10μF,50V
C314			NCB21HK-471X	CAPACITOR 470pF,50V	C3004			NCB21EK-473X	CAPACITOR 0.047μF,25V
C315			QERF1CM-106	E CAPACITOR 10μF,16V	C3011			QETL0JM-338	E CAPACITOR 3300μF,6.3V

#	△ REF No.	PART No.	PART NAME, DESCRIPTION	#	△ REF No.	PART No.	PART NAME, DESCRIPTION
		C3012	QEKJ0JM-476 E CAPACITOR 47μF,6.3V			C6701	NRSA02J-0R0X MG RESISTOR 0Ω,1/10W
		C3014	QERF0JM-476 E CAPACITOR 47μF,6.3V			C6704	NCB21HK-103X CAPACITOR 0.01μF,50V
		C3016	NCB21EK-473X CAPACITOR 0.047μF,25V			C6707	NDC21HJ-470X CAPACITOR 47pF,50V
		C3022	NCB21EK-473X CAPACITOR 0.047μF,25V			C6708	NDC21HJ-8R0X CAPACITOR 8pF,50V
		C3024	NDC21HJ-120X CAPACITOR 12pF,50V			C6709	NDC21HJ-1R0X CAPACITOR 1pF,50V
		C3026	NCB21HK-103X CAPACITOR 0.01μF,50V			C6713	NCF21CZ-224X CAPACITOR 0.22μF,16V
		C3027	QEKJ1CM-106 E CAPACITOR 10μF,16V			C6714	NCB21HK-682X CAPACITOR 0.0068μF,50V
		C3030	QEKJ0JM-476 E CAPACITOR 47μF,6.3V			C6715	QEKJ1HM-225 E CAPACITOR 2.2μF,50V
		C3031	NCB21EK-473X CAPACITOR 0.047μF,25V			C6716	NCB21HK-682X CAPACITOR 0.0068μF,50V
		C3032	NCB21EK-473X CAPACITOR 0.047μF,25V			C6717	QEKJ1HM-225 E CAPACITOR 2.2μF,50V
		C3033	NCB21EK-473X CAPACITOR 0.047μF,25V			C6719	QEKJ1EM-106 E CAPACITOR 10μF,25V
		C3036	NDC21HJ-180X CAPACITOR 18pF,50V			C6720	QEKJ1EM-106 E CAPACITOR 10μF,25V
		C3037	NDC21HJ-120X CAPACITOR 12pF,50V			C6721	NCB21HK-103X CAPACITOR 0.01μF,50V
		C3040	NCB21EK-473X CAPACITOR 0.047μF,25V			C6723	NCB21HK-103X CAPACITOR 0.01μF,50V
		C3041	NDC21HJ-100X CAPACITOR 10pF,50V			C6724	QEKJ1HM-225 E CAPACITOR 2.2μF,50V
		C3045	NDC21HJ-101X CAPACITOR 100pF,50V			C7001	NCB21HK-103X CAPACITOR 0.01μF,50V
		C3050	NCF21EZ-104X CAPACITOR 0.1μF,25V			C7002	QEKJ0JM-476 E CAPACITOR 47μF,6.3V
		C3051	NCB21EK-104X CAPACITOR 0.1μF,25V			C7011	QEKJ0JM-227 E CAPACITOR 220μF,6.3V
		C3101	QER61CM-106 E CAPACITOR 10μF,16V			C7012	NCB21HK-103X CAPACITOR 0.01μF,50V
		C4002	QDYB1CM-103Y CAPACITOR 0.01μF,16V			C7103	NCB21HK-681X CAPACITOR 680pF,50V
		C4003	NCB21HK-102X CAPACITOR 0.001μF,50V			C7104	NCB21HK-681X CAPACITOR 680pF,50V
		C4004	QERF1CM-226 E CAPACITOR 22μF,16V			C7117	QUY153-050Y IM BUS WIRE
		C4005	NCB21HK-222X CAPACITOR 0.0022μF,50V			C7119	NCB21HK-471X CAPACITOR 470pF,50V
		C4006	QERF0JM-476 E CAPACITOR 47μF,6.3V			C7120	NCB21HK-471X CAPACITOR 470pF,50V
		C4007	NCB21HK-561X CAPACITOR,J780MS/J781MS 560pF,50V			C7128	QEKJ1CM-107 E CAPACITOR 100μF,16V
		C4008	QEQF1HM-105 NP E CAPACITOR 1μF,50V			C7129	NCB31CK-104X CAPACITOR 0.1μF,16V
		C4009	NCB21HK-563X CAPACITOR 0.056μF,50V			C7131	QUY153-050Y IM BUS WIRE
		C4010	NCB21EK-223X CAPACITOR 0.022μF,25V			C7132	QETN1CM-107 E CAPACITOR 100μF,16V
		C4011	NCB21EK-104X CAPACITOR 0.1μF,25V			C7133	NCB21HK-103X CAPACITOR 0.01μF,50V
		C4012	QERF1HM-105 E CAPACITOR 1μF,50V			C7134	NCB31CK-473X CAPACITOR 0.047μF,16V
		C4013	NCB21HK-563X CAPACITOR 0.056μF,50V			C7135	NCB31CK-473X CAPACITOR 0.047μF,16V
		C4014	NDC21HJ-101X CAPACITOR 100pF,50V			C7136	NCB31CK-473X CAPACITOR 0.047μF,16V
		C4015	NCB21HK-102X CAPACITOR 0.001μF,50V			C7137	NDC21HJ-330X CAPACITOR 33pF,50V
		C4016	NDC21HJ-101X CAPACITOR 100pF,50V			C7138	QEKJ1EM-106 E CAPACITOR 10μF,25V
△		C5001	QFZ9073-683 F CAPACITOR 0.068μF,250V			C7139	QEKJ1CM-476 E CAPACITOR 47μF,16V
△		C5002	QFZ9051-333 F CAPACITOR 0.033μF,250V			C7140	QEKJ1EM-106 E CAPACITOR 10μF,25V
△		C5004	QCZ9071-222 CAPACITOR 0.0022μF,400V			C7141	QEKJ1EM-106 E CAPACITOR 10μF,25V
		C5006	QEZ0375-686 E CAPACITOR 68μF,400V			C7142	QEKJ1EM-106 E CAPACITOR 10μF,25V
		C5101	QCZ0212-472 CAPACITOR 0.0047μF,1kV			C7143	QEKJ1EM-106 E CAPACITOR 10μF,25V
		C5102	QCZ0302-330Z CAPACITOR 33pF,1kV			C7144	QEKJ1EM-106 E CAPACITOR 10μF,25V
		C5104	QEK1HM-105 E CAPACITOR 1μF,50V			C7145	QEKJ1EM-106 E CAPACITOR 10μF,25V
		C5105	QFN31HJ-183 F CAPACITOR 0.018μF,50V			C7146	QEKJ1HM-475 E CAPACITOR 4.7μF,50V
		C5106	QCB1HJ-271 CAPACITOR 270pF,50V			C7147	QEKJ1EM-106 E CAPACITOR 10μF,25V
		C5107	QFV91HJ-104 F CAPACITOR 0.1μF,50V			C7148	QEKJ1EM-106 E CAPACITOR 10μF,25V
		C5202	QEMT1CM-687 E CAPACITOR 680μF,16V			C7149	QEKJ1HM-475 E CAPACITOR 4.7μF,50V
		C5203	QEMT1AM-128 E CAPACITOR 1200μF,10V			C7150	QEKJ1EM-106 E CAPACITOR 10μF,25V
		C5204	QETN2AM-475 E CAPACITOR 4.7μF,100V			C7151	QEKJ1EM-106 E CAPACITOR 10μF,25V
		C5206	QETN1AM-476 E CAPACITOR 47μF,10V			C7152	NCB21EK-473X CAPACITOR 0.047μF,25V
		C5207	QETN1CM-107 E CAPACITOR 100μF,16V			C7153	NDC21HJ-330X CAPACITOR 33pF,50V
		C5301	QEKJ1CM-107 E CAPACITOR 100μF,16V			C7155	QEKJ1EM-106 E CAPACITOR 10μF,25V
		C5302	QETJ1CM-107 E CAPACITOR 100μF,16V			C7164	NCB21HK-681X CAPACITOR,J780MS/J781MS 680pF,50V
		C5303	QEKJ1CM-107 E CAPACITOR 100μF,16V			C7166	NCB21HK-681X CAPACITOR,J780MS/J781MS 680pF,50V
		C5304	QFLC1HJ-102Z F CAPACITOR 0.001μF,50V			C7168	NCB21HK-681X CAPACITOR 680pF,50V
		C5305	QFV91HJ-154 F CAPACITOR 0.15μF,50V			C7169	NCB21HK-681X CAPACITOR 680pF,50V
		C6007	QEKCOJM-227 E CAPACITOR 220μF,6.3V			C7170	NCB21HK-821X CAPACITOR 820pF,50V
		C6012	QEKJ1AM-107 E CAPACITOR 100μF,10V			C7171	NCB21HK-821X CAPACITOR 820pF,50V
		C6013	NCB21HK-103X CAPACITOR 0.01μF,50V			C7172	NDC21HJ-101X CAPACITOR 100pF,50V
		C6023	NRSA02J-0R0X MG RESISTOR 0Ω,1/10W			C7173	NDC21HJ-101X CAPACITOR 100pF,50V
		C6027	NCB21HK-103X CAPACITOR 0.01μF,50V			C7174	NCB21HK-681X CAPACITOR 680pF,50V
		C6037	QEKJ1CM-106 E CAPACITOR 10μF,16V			C7175	NCB21HK-681X CAPACITOR 680pF,50V
		C6501	QEKJ0JM-227 E CAPACITOR,J780MS/J781MS 220μF,6.3V			C7202	QETJ0JM-477 E CAPACITOR,J680MS/J780MS/J781MS 470μF,6.3V

#	△	REF No.	PART No.	PART NAME, DESCRIPTION		#	△	REF No.	PART No.	PART NAME, DESCRIPTION	
L1			QQL29BJ-100Z	COIL	10μH	K2001		NQL103K-R10X	COIL		0.1μH
L2			QQL071J-221Y	COIL	220μH	K2002		NQL103K-R10X	COIL		0.1μH
L3			QQL29BJ-100Z	COIL	10μH	K2003		NQL103K-R10X	COIL		0.1μH
L4			QQL29BJ-100Z	COIL	10μH	K2004		NQL103K-R10X	COIL		0.1μH
L5			QQL29BJ-100Z	COIL	10μH	K2251		NRSA02J-0R0X	MG RESISTOR		0Ω,1/10W
L12			QQR0967-001	COIL	12μH	K2252		NRSA02J-0R0X	MG RESISTOR		0Ω,1/10W
L13			QQL071J-330Y	COIL	33μH	K2253		NRSA02J-0R0X	MG RESISTOR		0Ω,1/10W
L14			QQL29BJ-101Z	COIL	100μH	K5101		QQR0678-001Z	FERRITE BEAD		
L20			QUY153-050Y	IM BUS WIRE		K5102		QQR0678-001Z	FERRITE BEAD		
L22			QQL231J-1R0Y	COIL	1μH	K6080		NRSA02J-102X	MG RESISTOR		1kΩ,1/10W
L24			QQL071J-270Y	COIL	27μH	K6701		NQR0200-003X	FERRITE BEAD		
L27			QQL071J-330Y	COIL	33μH	K6702		NQR0200-003X	FERRITE BEAD		
L28			QQL071J-680Y	COIL	68μH	K6703		NRSA02J-101X	MG RESISTOR		100Ω,1/10W
L201			QQL29BK-1R0Z	COIL	1μH	K6704		NRSA02J-101X	MG RESISTOR		100Ω,1/10W
L202			QQL071J-330Y	COIL,J680MS/J780MS/J781MS	33μH	K6705		NQR0200-003X	FERRITE BEAD		
			QUY153-050Y	IM BUS WIRE,J580MS		K6706		NQR0200-003X	FERRITE BEAD		
L203			QQL29BJ-220Z	COIL	22μH	K6707		NQR0200-003X	FERRITE BEAD		
L204			QUY153-050Y	IM BUS WIRE,J680MS/J780MS/J781MS		K7001		NQR0403-003X	FERRITE BEAD		
L206			QQL071J-220Y	COIL	22μH	PC3001		GP3S123	IC(PHOTO SENSOR)		
L207			QUY153-050Y	IM BUS WIRE		PC3002		GP3S123	IC(PHOTO SENSOR)		
L301			QQL29BJ-100Z	COIL	10μH	△ PC5101		PS2561L1-1/L/	IC(PHOTO COUPLER)		
L302			QQL29BJ-6R8Z	COIL	6.8μH	T2051		PELN0832	OSC TRANSFORMER,J580MS/680MS		
L303			QQL231J-270Y	COIL	27μH			PELN0860	OSC TRANSFORMER,J780MS/J781MS		
L2001			QUY153-050Y	IM BUS WIRE		T2052		PELN0861	OSC TRANSFORMER,J780MS/J781MS		
L2251			QQL29BJ-100Z	COIL	10μH	△ T5001		QQS0083-001	SW TRANSFORMER		
L2252			QQL29BJ-151Z	COIL	150μH	TU6001		QAU0210-001	TUNER		
L3101			QQL29BJ-100Z	COIL	10μH	ET1		PQ21623-2-5	EARTH PLATE(RF)		
L5201			PELN1184	COIL	33μH	HS1		LP40090-001A	HEAT SINK,Q5101		
L5202			PELN1184	COIL	33μH	△ TB1		LP20317-003B	TERM.BOARD(PAL),J580MS		
L6001			QQL29BK-1R0Z	COIL	1μH	△		LP20317-005A	TERM.BOARD(PAL),J680MS		
L6003			QQL29BJ-470Z	COIL	47μH	△		LP20317-007A	TERM.BOARD(PAL),J780MS/J781MS		
L7101			NRSA02J-0R0X	MG RESISTOR	0Ω,1/10W	DI7001		LTG-Y2K16M-J	LE DIODE		
L7102			NQL092M-R22X	COIL	0.22μH	SD1		LP21033-001A	SHIELD CASE(PRE)		
L7105			QQL231J-1R0Y	COIL	1μH	OT1		QYTDST3006Z	SCREW,Q5101		
L7106			QQL231J-1R0Y	COIL	1μH	FC5001		QNG0006-001Z	FUSE CLIP,F5001		
L7107			QQL01BJ-100Z	COIL	10μH	FC5002		QNG0006-001Z	FUSE CLIP,F5001		
L7108			QUY153-050Y	IM BUS WIRE		J7101		PEMC1104	RGB21PIN SOCKET,AV1		
L7109			QQL231J-R22Y	COIL	0.22μH	J7102		PEMC1104	RGB21PIN SOCKET,AV2		
L7201			QQL01BJ-101Z	COIL,J680MS/J780MS/J781MS	100μH	J7103		QNN0292-003	PIN JACK		
X1			QAX0576-001Z	CRYSTAL RESONATOR		J7105		QNN0381-002	PIN JACK,FRONT IN,J780MS/J781MS		
X3001			QAX0444-001	CRYSTAL RESONATOR		△ LF5001		PELN1204-01-01	LINE FILTER		
X3002			QAX0527-001	CRYSTAL RESONATOR		△ LF5002		QQR0978-001	LINE FILTER		
X6701			QAX0443-001	CRYSTAL RESONATOR		CN1		QGF1028C1-11	FPC CONNECTOR,(1-11)U.DRUM		
S3001			QSW0602-004	PUSH SWITCH,REC SAFETY		CN2001		QGF1207C1-07	FPC CONNECTOR,(1-7)A/C HEAD		
S7001			QSW0456-002Z	TACT SWITCH,STAND-BY		CN2002		QGB2532J1-02	CONNECTOR,(1-2)FE HEAD		
S7002			QSW0456-002Z	TACT SWITCH,TIMER,J580MS		CN3001		QGF1207C1-05	FPC CONNECTOR,(1-5)DRUM MDA		
			QSW0456-002Z	TACT SWITCH,CH-,J680MS/J780MS/J781MS		CN3002		QGB2532J1-02	CONNECTOR,(1-2)LOADING MOTOR		
S7004			QSW0456-002Z	TACT SWITCH,CH-,580MS		CN3003		QGB2015M2-08	CONNECTOR,(1-8)CAPSTAN MOTOR		
			QSW0456-002Z	TACT SWITCH,REC,J680MS/J780MS/J781MS		CN3004		QGB2534J2-04	CONNECTOR,(1-4)ROTARY ENCODER		
S7006			QSW0456-002Z	TACT SWITCH,CH+,J580MS		△ CN5001		QGA7901C3-02	CONNECTOR,(1-2)AC IN		
			QSW0456-002Z	TACT SWITCH,PAUSE,J680MS/J780MS/J781MS		CN7001		QGF1207C1-09	FPC CONNECTOR,(1-9)FRONT,J580MS/J780MS/J781MS		
S7008			QSW0456-002Z	TACT SWITCH,STOP/EJECT,J680MS/J780MS/J781MS		△ CP4001		ICP-N25	CIRCUIT PROTECTOR		
S7010			QSW0456-002Z	TACT SWITCH,DISPLAY,J580MS		△ CP5302		ICP-N25	CIRCUIT PROTECTOR		
			QSW0456-002Z	TACT SWITCH,SAT.TIMER,J680MS/J780MS/J781MS		△ F5001		QMF51E2-2R0J1	FUSE		T2.0A,AC250V
S7011			QSW0456-002Z	TACT SWITCH,REC,J580MS							
S7012			QSW0456-002Z	TACT SWITCH,PLAY,J680MS/J780MS/J781MS							
S7013			QSW0456-002Z	TACT SWITCH,PAUSE,J580MS							
S7014			QSW0456-002Z	TACT SWITCH,REW,J680MS							
S7015			QSW0456-002Z	TACT SWITCH,STOP/EJECT,J580MS/J680MS							
S7016			QSW0456-002Z	TACT SWITCH,SAT.TIMER,J580MS							
			QSW0456-002Z	TACT SWITCH,CH+,J680MS/J780MS/J781MS							

△ REF No. PART No. PART NAME, DESCRIPTION

△ REF No. PART No. PART NAME, DESCRIPTION

MINI FRONT BOARD ASSEMBLY (HR-J580MS) <28>

PW1	LPA20005-01A	MINI FRONT BOARD ASSY	
R7043	QRE141J-272Y	RESISTOR	2.7kΩ,1/4W
R7044	QRE141J-472Y	RESISTOR	4.7kΩ,1/4W
R7045	QRE141J-682Y	RESISTOR	6.8kΩ,1/4W
S7021	QSW0456-002Z	TACT SWITCH,REW	
S7022	QSW0456-002Z	TACT SWITCH,FF	
S7023	QSW0456-002Z	TACT SWITCH,PLAY	
CN7002	QGF1208C1-09	FPC CONNECTOR,(1-9)MAIN	